

### Internal waterproofing and horizontal barrier from outside

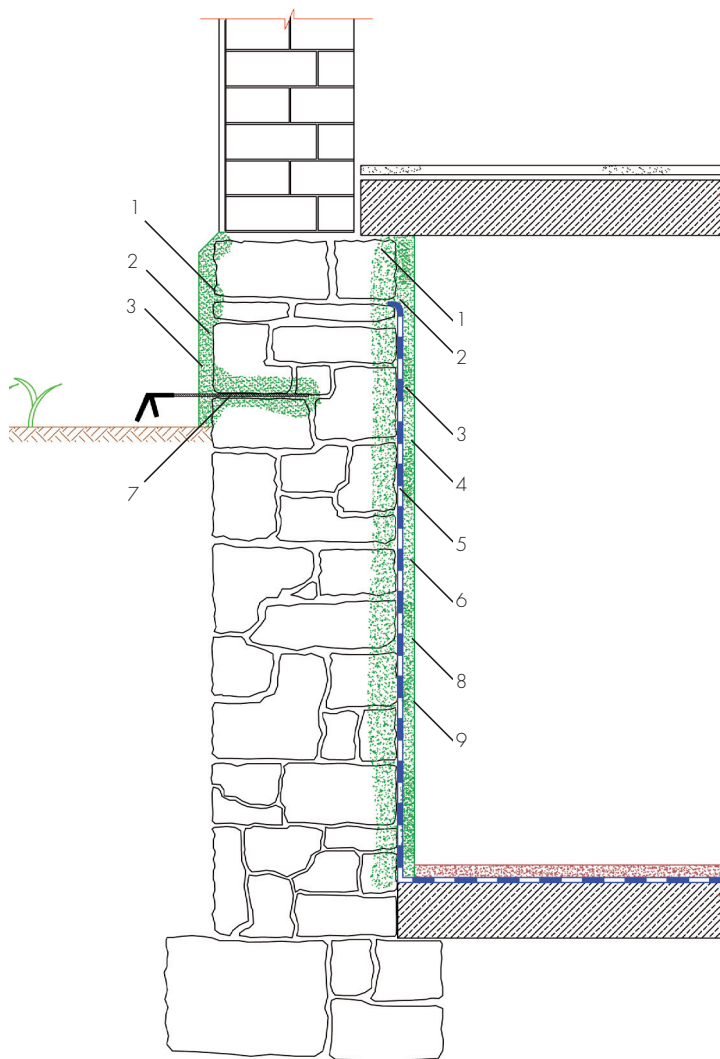

1. Salt treatment with ESCO-FLUAT
  2. Semi-covered rough cast THERMOPAL-SP
  3. Restoration plaster THERMOPAL-SR24 or THERMOPAL-SR44
  4. Fully-covered rough cast with THERMOPAL-SP
  5. Levelling plaster MG III with addition of ASOPLAST-MZ
  6. Waterproofing with AQUAFIN-1K
  7. Horizontal barrier with AQUAFIN-F or AQUAFIN-IB2
- Horizontal barrier: with pressure  
 Hole depth: brick. / . 5 cm  
 Hole distance: 10-12 cm
8. Fine plaster THERMOPAL-FS33
  9. Silicate paint ADICOR-SK