

## The Finnish channel

Wear classes A, B and water impact classes W3-I, W1-B and W2-B

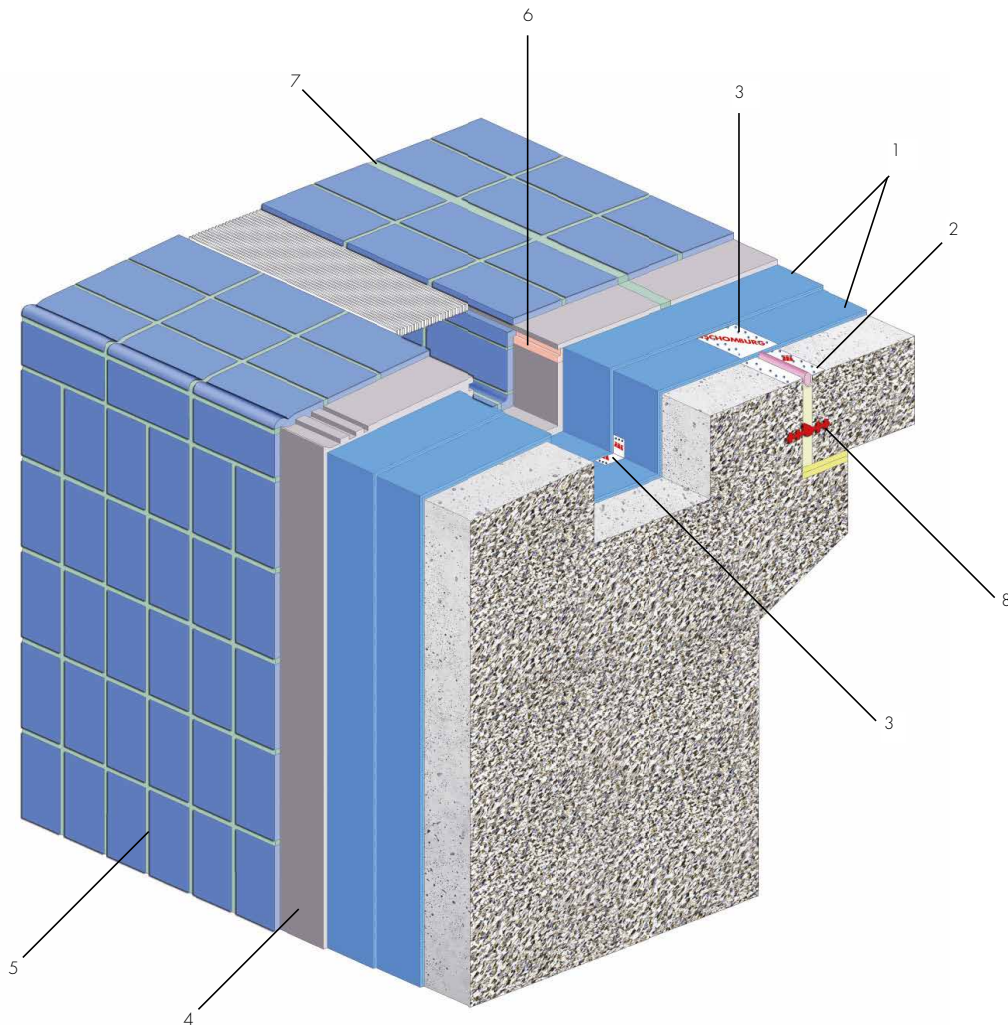

- 1 Waterproofing with AQUAFIN-2K/M-PLUS or AQUAFIN-RS300\*
- 2 ASO-Joint-Tape-2000-S embedded in AQUAFIN-2K/M-PLUS or AQUAFIN-RS300\*
- 3 ASO-Joint-Tape-2000 embedded in AQUAFIN-2K/M-PLUS or AQUAFIN-RS300\*
- 4 SOLOFLEX or UNIFIX-S3 thin-bed mortar
- 5 HF05-Brillantfuge or ASODUR-EK98 joint mortar
- 6 ASODUR-EP/FM capillary-breaking joint filler
- 7 ESCOSIL-2000-UW elastic grouting compound
- 8 Concrete joint strip

\* water depth of up to 6 m