

Assured tile installation in swimming pools and water parks

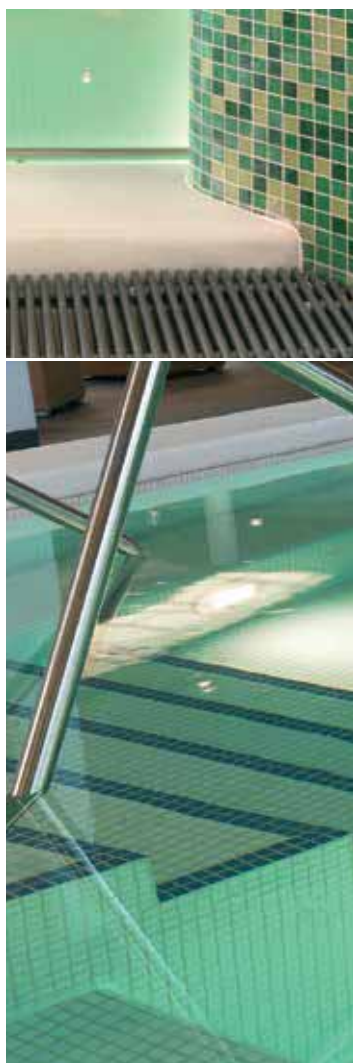



Contents

04 - 05	Assured waterproofing
06 - 07	Showers, sanitary areas and changing areas
08 - 09	Dry and steam saunas
10 - 11	Pool edge details and pool surrounds
12 - 15	Swimming pool systems
16 - 17	Penetrations and inserts Special case: green concrete substrates
18 - 19	Waterproof concrete
20 - 21	Product overview
22 - 23	References



Lebiaschij Aqua park
Minsk, Belarus

Assured waterproofing in swimming pools

Activities for remaining healthy are of great significance in our performance orientated society. For decades, swimming pools and water parks have been the most popular recreational places for the free time of all age groups.

The demands on this type of construction are constantly rising and international experiences in swimming pool construction show that reinforced concrete shells clad with ceramic tiles fulfil these requirements the best and most efficiently.

Swimming pools without water are like towns without people. Water is certainly falsely listed as the biggest enemy of each construction.

Without doubt, most damage is caused by water. The safest and most economical way to prevent moisture damage is to install a waterproof system in combination with tiles.

Tried and tested SCHOMBURG system construction products are available to waterproof in a wide variety of situations, even problematical areas and under heavy duty conditions, and to install the tiles selected.



SCHOMBURG offers complete solutions to waterproofing and tiling all areas of a swimming pool. Our systems are particularly renowned for their reliability and efficiency.



The thrill of ambitious leisure designs in adventure pools on your doorstep, sporting competitions in standardised Olympic pools and also recuperation in therapeutic pools, would lose much significance without ceramic tiles.

Waterproof membranes and tile adhesives are subjected to particularly high levels of intense exposure to water and essential hygiene. Effective planning without a systematic approach is almost impossible in the challenging world of swimming pool architecture. This means the highest measures of planning care and the use of tested and proven system based products as well as technically correct implementation.

A modern swimming pool is a complex of the most varied constructions and spatialities, specific to its functions:

- Changing rooms
- Communal showers and sanitary areas
- Swimming pool surrounds
- Pool shells with traditional water
- Salt water pools and thermal pools
- Saunas
- Quiet zones
- Technical rooms etc.





Waterproofing and tiling in communal showers and sanitary areas

In commercial wet rooms requires particular types of waterproofing due to the large volume of water contact. The use of bonded waterproof membranes (including tile adhesives and tiles) protect all building components from moisture. All structural components (pipe penetrations, floor drains, shower mountings etc.) must be technically integrated into the waterproofing layer.



PRIMING

- ▶ Solvent free universal primer, resistant to water and alkalis
- ▶ Contact and bonding slurry for cement-based screeds

ASO®-Unigrund
ASOCRET-HB-flex



LEVELLING

- ▶ Non-sag, cement-based, rapid hardening, polymer modified, low stress and creamy smoothing compound, 2-15 mm for walls
- ▶ Water repellent, rapid hardening screeding mortar with high strength

SOLOCRET-15

ASO®-EZ4-Plus



WATERPROOFING

- ▶ Flexible, mineral-based, vapour permeable waterproofing slurry for heavier duty use in interior and exterior areas
Alternative: Hybrid waterproof membrane for critical applications (low temperatures and high humidity, work under time pressure)
- ▶ Joint tape for bridging bay joints and connecting joints

AQUAFIN®-2K/M
AQUAFIN®-2K
AQUAFIN®-RS300

ASO®-Joint-Tape-2000



TILE INSTALLATION

- ▶ Mineral-based, flexible thin-bed adhesive

SOLOFLEX



GROUTING / SEALING

- ▶ Rapid hardening, flexible grout, 3-20 mm joint width
- ▶ Silicone sealant for underwater areas

ASO®-Flexfuge
ESCOSIL®-2000-UW



Waterproofing and tiling in changing areas

Each swimming pool begins and ends with the changing area. There are not such high levels of moisture exposure here compared with the usual swimming pool areas but it can, however, be described as a wet area. The amount of water carried from the pool shell into the changing area by bathers is not to be underestimated. The chosen bonded tile system must survive the daily cleaning regime for the floor, the cleaning chemicals and pressure washing, without causing damage.



PRIMING

- ▶ Solvent free universal primer, resistant to water and alkalis
- ▶ Contact and bonding slurry for cement-based screeds

ASO®-Unigrund
ASOCRET-HB-flex



LEVELLING

- ▶ Non-sag, cement-based, rapid hardening, polymer modified, low stress and creamy smoothing compound, 2-15 mm for walls
- ▶ Rapid hardening screeding mortar with high strength, foot traffic after 6 hours, install tiles after 3 days

SOLOCRET-15

ASO®-EZ2-Plus



WATERPROOFING

- ▶ Flexible, mineral-based, vapour permeable waterproofing slurry for heavier duty use in interior and exterior areas
Alternative: Hybrid waterproof membrane for critical applications (low temperatures and high humidity, work under time pressure)
- ▶ Joint tape for bridging bay joints and connecting joints

AQUAFIN®-2K/M
AQUAFIN®-2K
AQUAFIN®-RS300

ASO®-Joint-Tape-2000



TILE INSTALLATION

- ▶ Mineral-based, flexible thin-bed adhesive

SOLOFLEX



GROUTING / SEALING

- ▶ Rapid hardening, flexible grout, 3-20 mm joint width
- ▶ Silicone sealant for underwater areas

ASO®-Flexfuge
ESCOSIL®-2000-UW



Waterproofing and tiling in

dry saunas

Finnish sauna · tepidarium · laconium

The sauna landscape consists of a variety of areas (e.g. dry saunas, showers and other wet rooms), which are subjected to different levels of exposure. The waterproofing and tiling systems must therefore be matched to the particular type of exposure. In a commercially used dry sauna, a high quality waterproof membrane is essential. In this case the waterproofing membrane bonded with the tiles, should be able to resist the high temperatures and regular cleaning without being damaged. A mineral-based waterproofing and tiling system can be used here.



PRIMING

- ▶ Solvent free universal primer, resistant to water and alkalis
- ▶ Contact and bonding slurry for cement-based screeds

ASO®-Unigrund
ASOCRET-HB-flex



LEVELLING

- ▶ Non-sag, cement-based, rapid hardening, polymer modified, low stress and creamy smoothing compound, 2-15 mm for walls
- ▶ Water repellent, rapid hardening screeding mortar with high strength

SOLOCRET-15

ASO®-EZ4-Plus



WATERPROOFING

- ▶ Flexible, mineral-based, vapour permeable waterproofing slurry for heavier duty use in interior and exterior areas
Alternative: Hybrid waterproof membrane for critical applications (low temperatures and high humidity, work under time pressure)
- ▶ Joint tape for bridging bay joints and connecting joints

AQUAFIN®-2K/M
AQUAFIN®-2K
AQUAFIN®-RS300

ASO®-Joint-Tape-2000



TILE INSTALLATION

- ▶ Mineral-based, flexible thin-bed adhesive

SOLOFLEX



GROUTING / SEALING

- ▶ Cement-based, water impermeable grout with enhanced mechanical and chemical resistance for joint widths of 3-20 mm
- ▶ Silicone sealant for underwater areas

HF05-Brillantfuge





ESCOSIL®-2000-UW



Waterproofing and tiling in steam saunas

Russian Banya · Turkish Hamam · Caldarium
Kraxen stove bath · Roman bath

Due to the high demands from steam in a steam sauna, the waterproof membrane and the installation system must additionally have a vapour barrier function, in order to protect water sensitive building components such as e.g. building panels in polystyrene from becoming damp from water vapour. In commercial steam saunas, this can only be achieved with reaction resin systems. Waterproofing and tiling in private steam saunas, which are only occasionally used, can be carried out with mineral-based systems as in dry saunas.

	PRIMING	<ul style="list-style-type: none"> ▶ Epoxy resin-based vapour barrier for floors/walls and overhead areas ▶ Contact and bonding slurry for cement-based screeds 	INDUFLOOR®-IB1240/1245 ASOCRET-HB-flex
	LEVELLING	<ul style="list-style-type: none"> ▶ Non-sag, cement-based, rapid hardening, polymer modified, low stress and creamy smoothing compound, 2-15 mm for walls ▶ Water repellent, rapid hardening screeding mortar with high strength 	SOLOCRET-15 ASO®-EZ4-Plus
	WATERPOOFING	<ul style="list-style-type: none"> ▶ Two component, solvent free, pigmented polyurethane resin. Elastic, with crack-bridging properties and good chemical resistance ▶ Joint tape for bridging bay joints and connections 	ASOFLEX-AKB-Floor/Wall ASO®-Joint-Tape-2000
	TILE INSTALLATION	<ul style="list-style-type: none"> ▶ Chemical resistant bonding and grouting based on epoxy resin, pigmented, VOC free, water vapour impermeable 	ASODUR®-Design
	GROUTING / SEALING	<ul style="list-style-type: none"> ▶ Chemical resistant bonding and grouting based on epoxy resin, pigmented, VOC free, water vapour impermeable ▶ Silicone sealant for underwater areas 	ASODUR®-Design ESCOSIL®-2000-UW

Pool edge detail systems and pool surrounds

Pool edge construction differs between high lying and low lying water levels. The pre-formed sections, whether channel linings or installed edging units, of the pool edge detail are a fundamental component of the pool shell hydraulics and water treatment.

The pool edge construction with high lying water levels offers a good perspective when swimming and 'beach characteristics'. They have no disruptive reflected waves and there can be no alarmingly unhygienic contamination deposited on the pool walls above the water level. Edge

detail construction with high lying water levels differs between vertical (e.g. Wiesbaden overflow channel) and sunken (e.g. Finnish overflow channel) boundaries.

A successful combination of overflow channel with high water levels and a pool shell with low lying water levels is depicted with therapy pools. In these cases, the pool surrounds are situated lower than the water level. The pool edge is constructed with a Wiesbaden overflow channel with high water levels but with a recessed inner edge.

The high level Wiesbaden overflow channel

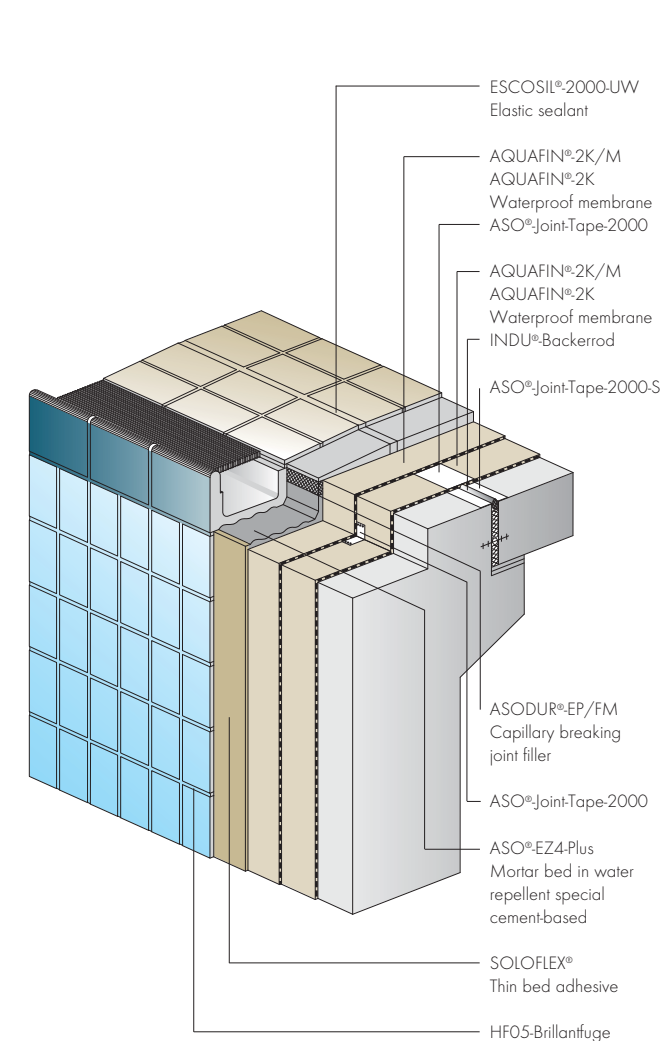

Finnish overflow channel

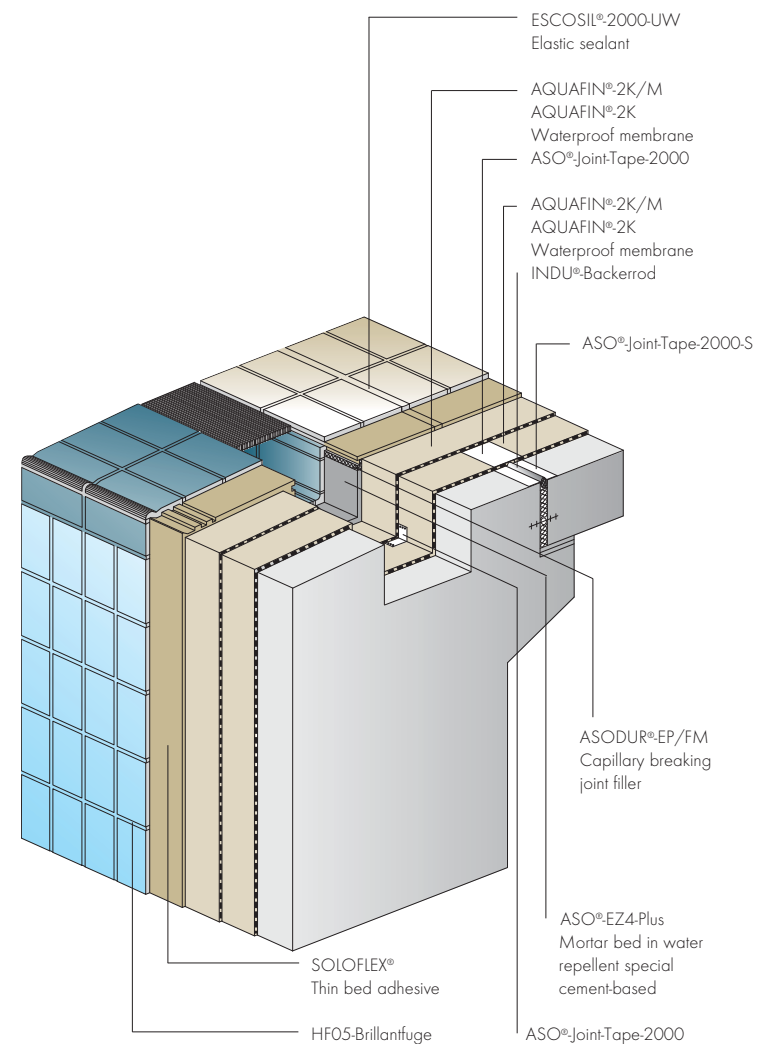



System build up in the pool

Example: swimming pool with traditional water

Waterproofing and tiling in swimming pools (with traditional water)

In order to prevent bathing water from penetrating the levelling coats and concrete structure of a swimming pool shell, suitable and approved waterproofing systems are used in a bonded system with the surface finishes. Before installing stone and ceramic finishes, the pool shell construction is to be tested for water tightness. The testing is carried out by a trial filling, for a duration of 14 days, with chlorinated water up to the upper edge of the pool edge detail. The minimum age of the concrete substrate is, as a rule, 6 months before tiling.

PRIMING	1	▶ Mineral-based corrosion protection and adhesion promoter for INDUCRET®-BIS-5/40 ▶ Contact and bonding slurry for cement-based screed	INDUCRET®-BIS-0/2 ASOCRET-HB-flex
	2	▶ Cement-based repair mortar 5-40 mm ▶ Water repellent, rapid hardening screed mortar with high strength	INDUCRET®-BIS-5/40 ASO®-EZ4-Plus
WATERPROOFING	3	▶ Flexible, mineral-based, vapour permeable waterproofing slurry for heavier duty use in interior and exterior areas	AQUAFIN®-2K/M AQUAFIN®-2K AQUAFIN®-RS300
	4	Alternative: hybrid waterproof membrane for critical applications (low temperatures and high humidity, work under time pressure)	
	5	▶ Special joint tape for increased requirements and heavy duty use	ASO®-Joint-Tape-2000-S ASO®-Joint-Sleeve-Floor
	6	▶ Special waterproof pre-formed pieces	
TILE INSTALLATION	7	▶ Mineral-based, flexible thin-bed adhesive	SOLOFLEX
GROUTING/ SEALING	8	▶ Cement-based, water impermeable grout with enhanced mechanical and chemical resistance for joint widths of 3-20 mm	HF05-Brillantfuge
		▶ Silicone sealant for underwater areas	ESCOSIL®-2000-UW
	9	▶ Internal joint sealing (details see page 19)	
	10	▶ Capillary breaking joint (details see page 15)	







Example: swimming pool with brine water



Waterproofing and tiling in swimming pools (with brine water)

In addition to pools filled with traditional bathing water, brine water pools and their surrounds are subjected to chemical exposure from minerals and salts. Waterproof membranes and adhesives used in these areas must be resistant to them. The optional use of a conductive strip and a conductive coating between primer and waterproofing membrane gives the possibility of testing the waterproofing membrane for water tightness without destruction using a spark coil test under high voltage, so that the time-consuming and costly assessment of pool waterproofing via the 14 day trial filling with water can be dispensed with. In this case our **DENSARE®-2002** system is used.

	PRIMING	11 ▶ Universal primer based on epoxy resin, low viscosity	INDUFLOOR®-IB1270
	LEVELLING	12 ▶ Epoxy resin based repair mortar	INDUFLOOR®-IB4010
	WATERPROOFING	13 ▶ Self adhesive copper conductive strip (for control level, optional)	INDU®-ConductiveStrip INDUFLOOR®-IB2115 ASO®-Joint-Tape-2000-S ASO®-Joint-Sleeve-Floor ASOFLEX-AKB-Floor/Wall
		5 ▶ Aqueous conductive coating based on epoxy resin (for control level, optional)	
		5 ▶ Special waterproof tape for higher requirements and heavy duty	
		6 ▶ Special waterproof pre-formed pieces	
		14 ▶ 2 component, solvent free, pigmented polyurethane resin. Elastic, with crack-bridging properties and good chemical resistance, blue and grey	
	TILE INSTALLATION	15 ▶ Chemical resistant bonding and grouting based on epoxy resin, pigmented, VOC free, water vapour impermeable ▶ Epoxi-based tiling adhesives and jointing mortar for wall areas	ASODUR®-Design ASODUR®-EK98-Wall
	GROUTING / SEALING	16 ▶ Chemical resistant bonding and grouting based on epoxy resin, pigmented, VOC free, water vapour impermeable	ASODUR®-Design ESCOSIL®-2000-UW
		9 ▶ Silicone sealant for underwater areas	
		9 ▶ Internal joint sealing (details see page 19)	
		10 ▶ Capillary breaking joint (details see page 15)	



The installation of pool edge tiles and pre-formed units on to the pool edge is particularly well proven with the hydrophobic screed and bedding mortar, ASO®-EZ4-Plus, in external pools. The risk of frost damage, which is very high at the pool edge detail in external pools, is considerably reduced through the mortar's special properties, when correctly installed without voids.

Capillary breaking joint

The water level lies higher or at least at the same surface level as the ceramic tiling on the pool surround. This causes capillary water pressure, which leads to water in the floor construction of the pool surround if planning and implementation is not carried out properly or technically correct.

The problem is solved by a special capillary breaking joint which prevents capillary water transportation. A safe and effective design for such a joint is guaranteed through the use of ASODUR®-EP/FM – a product which was specially developed for this purpose.

Therapy pools (brine pools)

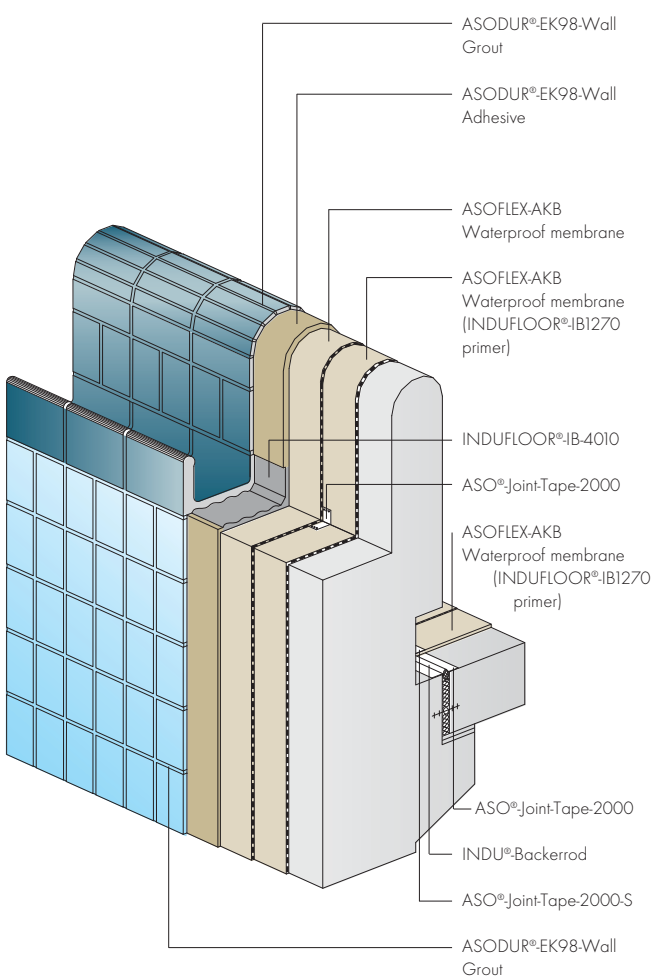

Pool surrounds

The pool shell construction is to be structurally separated from the other load-bearing constructions of a swimming pool. An optimum solution is e.g. the simple support of the pool surround on the pool shell. A movement joint is incorporated at the jointing point. In the course of the waterproofing measures, the joint is waterproofed with ASO®-Joint-Tape-2000-S and the associated pre-formed pieces. It is to be noted that the position of the expansion joint at a width of 10–20 mm is determined by the Structural Engineer and appropriately allowed into the structural calculations. There are usually various plant rooms beneath the pool surround which are to be protected from water. When selecting a waterproofing system for the pool surround presume the same demands as for the associated pool shell.



Waterproofing

penetrations and inserts

Inserts with an adhesive flange of approx. 5 cm in width have proven themselves for the assured waterproofing of penetrations and fixing points. In the ideal case, such inserts are allowed for during planning and are already present in the design plans. During concrete works, they are simply inserted into the body of the concrete. Waterproofing such inserts is easy, quick and secure – after bonding the ASO®-Joint-Sleeve, the waterproof membrane is applied and overlapped onto the flange.

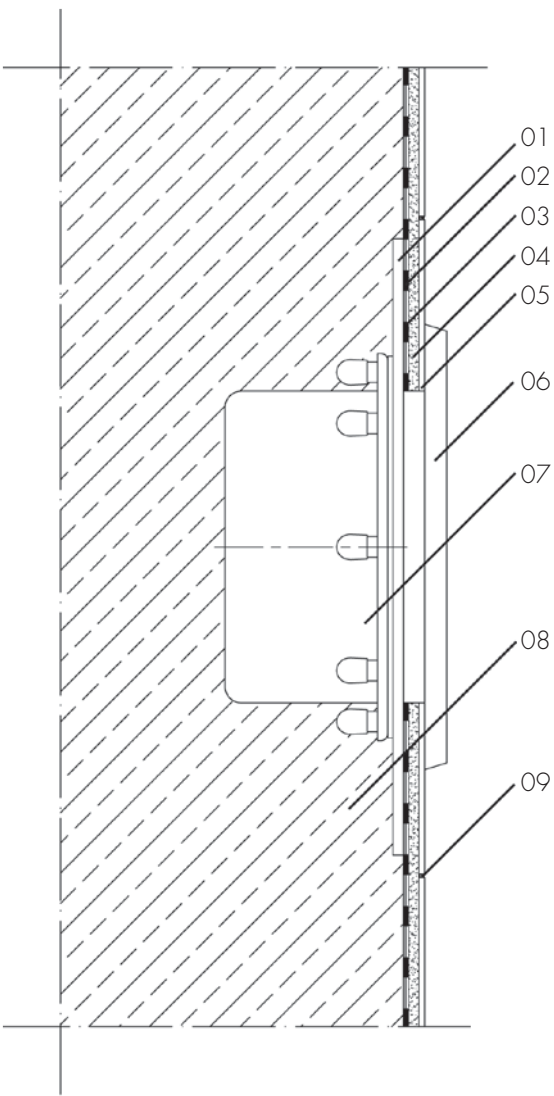

TRADITIONAL WATER

- 01 ▶ Flange
- 02 ▶ ASO®-Joint-Sleeve-Floor
- 03 ▶ AQUAFIN®-2K/M, AQUAFIN®-2K or AQUAFIN®-RS300
- 04 ▶ SOLOFLEX
- 05 ▶ Tiles
- 06 ▶ Cover
- 07 ▶ Light housing
- 08 ▶ Concrete shell
- 09 ▶ HF05-Brillantfuge

BRINE WATER POOL / THERMAL WATER

- 01 ▶ Flange
- 02 ▶ ASO®-Joint-Sleeve-Floor
- 03 ▶ ASOFLEX-AKB-Wall
- 04 ▶ ASODUR®-EK98-Wall
- 05 ▶ Tiles
- 06 ▶ Cover
- 07 ▶ Light housing
- 08 ▶ Concrete shell
- 09 ▶ ASODUR®-Design



Special case

Tile installation in pools on green concrete substrates

(Pool shell age > 28 days < 6 months)

In standard methodology, tile installation in swimming pools cannot be carried out before 6 months after completion of the concreting works (dependent on ambient conditions and pool shell construction even later). There is a particular problem with installing tiles on green concrete, which is younger than 6 months. Concrete shrinkage is still very intense in this period and not complete by a long way. Consequentially considerable deformation and the appearance of micro-cracks are noticeable. The use of an elastic waterproof membrane together with the highly elastic tile adhesive, UNIFIX®-2K is an effective and safe solution.



WATERPROOFING

- Flexible, mineral-based, vapour permeable waterproofing slurry for heavier duty use in interior and exterior areas

AQUAFIN®-2K/M
AQUAFIN®-2K



TILE INSTALLATION

- 2 component, water impermeable, frost resistant flexible adhesive for tiled finishes under high stresses

UNIFIX®-2K



GROUTING / SEALING

- Rapid hardening, flexible grout, 3-20 mm joint width
- Silicone sealant for underwater areas

ASO®-Flexfuge
ESCOSIL®-2000-UW



Special case

Swimming pool shell as a waterproof concrete „white tub“

A 'white tub' is concerned with a swimming pool construction in concrete with increased resistance to water penetration. The concrete undertakes additional waterproofing measures having a load-bearing function as well as a waterproofing one. All structural elements (construction joints, penetrations, fixing points etc.) are also waterproof through special measures, so that, as a rule, no additional measures are necessary.

Planning and execution

Valuable and useful information and requirements are available from the German waterproofing guidelines from the DAfStb. When planning and carrying out works on a swimming pool as a 'white tub' use wet duty class 1 (water under pressure).

Utilization class A (no areas of moisture allowed) or B (areas of moisture allowed) are to be agreed for each case with the client.

Pool shell concrete

There are particularly high demands placed on the concrete: min. C25/30, $w/c < 0.55$; $t_{wall} \geq 240$ mm; $t_{floor} \geq 250$ mm; $w_{crack} \leq 0.2$ mm or ≤ 0.1 mm (dependent on utilization class). No concrete additives for crystalline waterproofing of the concrete shell are allowed.

High performance super plasticizers and mould release agents from SCHOMBURG help to fulfil the high demands.

REMICRETE-SP10

High performance super plasticizer

BLANKOL-LF

Universal release agent for all types of mould



Construction joints with pipe injection system

The pre-installation of PVC custom made injection pipes have proven to be an efficient system for waterproofing construction joints. In this way, it is possible to quickly and simply waterproof the concrete by injecting an injection resin, which disperses throughout the entire joint and potential defective areas in the concrete.

AQUAFIN®-CJ1

Injection pipe for waterproofing construction joints in concrete

AQUAFIN®-P1

Injection resin for waterproofing water bearing cracks

AQUAFIN®-P4

Elastic polyurethane injection resin

Waterproofing construction joints with a water bar

Treating construction joints with a water bar is a convenient but very safe possibility for waterproofing inner lying joints. The expansion of the jointing strip INDU-FLEX-CJ13 (up to 1100%) starts approx. 6 hours after contact with water and is reversible.

INDU-FLEX-CJ13

Expanding and jointing water bar for waterproofing construction joints



Product overview

	PROPERTIES
AQUAFIN®-2K/M AQUAFIN®-2K	▶ 2 component, flexible, cementitious mineral-based waterproofing slurry for new and existing buildings, channels and swimming pools
AQUAFIN®-RS300	▶ Rapid hybrid waterproof membrane for new and existing buildings, channels and swimming pools, can be tiled after 4 hours
AQUAFIN®-CJ1	▶ Injection pipe for the injection of all suitable injection resins, gels as well as acrylates, resistance to water under pressure
AQUAFIN®-P1	▶ 1 component, PU injection resin for waterproofing water bearing cracks and joints, ready to use
AQUAFIN®-P4	▶ 2 component, elastic PU injection resin for waterproofing cracks and joints using the pipe injection method
ASOCRET-HB-Flex	▶ Contact and bonding slurry for cement-based screeds
ASO®-Joint-Tape-2000	▶ Joint tape for normal use
ASO®-Joint-Tape-2000-S	▶ Special joint tape for high demands and heavy duty use
ASO®-Joint-Sleeve-Floor	▶ Pre-formed piece from the ASO®-Joint-Tape system for waterproofing floor drain outlets
ASODUR®-Design	▶ Fine epoxy grout and adhesive, for joint widths from 1 -7 mm, available in various colours
ASODUR®-EK98-Wall	▶ Adhesive and grout, for joint widths from 3 -15 mm
ASODUR®-EP/FM	▶ 2 component reaction resin anchoring grout
ASO®-EZ2-Plus	▶ Rapid hardening pre-blended factory produced mortar with high strength
ASO®-EZ4-Plus	▶ Rapid hardening, water repellent pre-blended factory produced mortar
ASO®-Flexfuge	▶ Polymer modified grout - rapid hardening, for joints from 3 -20 mm wide, available in various colours
ASO®-Unigrund-GE	▶ Ready to use, solvent free primer, coloured green
ASO®-Unigrund-K	▶ Solvent free primer concentrate, transparent or blue

ASOFLEX-AKB-Floor	▶ 2 component, solvent free, pigmented PU waterproofing membrane for use bonded to floors together with tiled finishes
ASOFLEX-AKB-Wall	▶ 2 component, solvent free, pigmented PU waterproofing membrane for use bonded to walls together with tiled finishes
BLANKOL-LF	▶ Universal release agent for all types of mould
ESCOSIL®-2000-UW	▶ Elastic, 1 component joint sealant based on silicone rubber, highly fungicidal, for the elastic jointing of movement and structural joints in underwater areas such as e.g. swimming pools
HF05-Brillantfuge	▶ High strength, flexible, cement-based grout for joints from 3–20 mm wide, available in 2 grey tones
INDU-FLEX-CJ13	▶ Thermoplastic expanding and jointing strip for waterproofing construction joints
INDU®-Backerrod	▶ Round profile, closed-cell backfill material for flexible joint sealants.
INDU®-ConductiveStrip	▶ Copper conductive strip for producing a control level in conductive waterproofing and floor coating systems
INDUCRET®-BIS-0/2	▶ Mineral-based corrosion inhibitor and bonding slurry for INDUCRET®-BIS-5/40
INDUCRET®-BIS-5/40	▶ Cement-based repair mortar, 5–40 mm
INDUFLOOR®-IB1240	▶ Oil and vapour barrier, low solvent, moisture tolerant, 2 component epoxy resin for floors
INDUFLOOR®-IB1245	▶ Oil and vapour barrier, low solvent, moisture tolerant, 2 component epoxy resin for walls and overhead areas
INDUFLOOR®-IB1270	▶ 2 component epoxy resin primer, solvent free, low viscosity
INDUFLOOR®-IB2115	▶ Aqueous conductive coating for producing control levels in conductive waterproofing and floor coating systems
INDUFLOOR®-IB2360	▶ Aqueous concrete sealer, free from organic solvents, use as a primer and sealer
INDUFLOOR®-IB4010	▶ 2 component epoxy resin repair mortar
REMICRETE-SP10	▶ High performance super plasticizer
SOLOCRET-15	▶ Non-sag, rapid hardening smoothing compound, suitable for swimming pool construction, for thicknesses from 2–15 mm in one layer
SOLOFLEX	▶ Flexible, thin and medium bed adhesive: DIN 12004, C2 TE; suitable for vitrified, earthenware, fully vitrified tiles, clinker, mosaic and natural stone materials, which are not sensitive to discolouration and not translucent
UNIFIX®-2K	▶ 2 component flexible adhesive, water impermeable, frost resistant: DIN 12004, C1 TE S2; suitable for the thin-bed installation of vitrified, earthenware, fully vitrified tiles, clinker, mosaic and natural stone materials, which are not sensitive to discolouration and not translucent

References

LEBJASCHIJ AQUAPARK, MINSK, BELARUS



► Concrete repair and waterproofing



GRAFT THERME, DELMENHORST, GERMANY



► Concrete repair, waterproofing,
tile installation and grouting



LAURA MOUNTAIN RESORT, SOCHI, RUSSIA



► Concrete repair, waterproofing,
tile installation and grouting

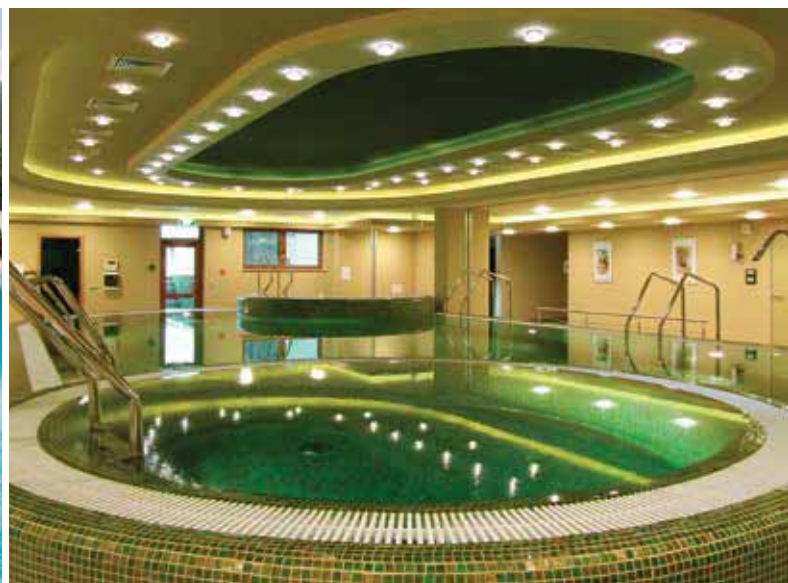

REHABILITATION CENTRE, LUXEMBOURG



► Waterproofing



The SCHOMBURG Group develops,
produces and markets high quality
building product systems for

- Construction waterproofing
- Construction restoration
- Tiles/natural stone installation
- Screed installation
- Civil engineering
- Surface protection
- Concrete technology

SCHOMBURG is recognised for its
development competency and is
distinguished both nationally and
internationally with over 75 years in
the market. System based construction
products from its own production plants
are held in high esteem throughout the
world.

Industry professionals value the level of
service provided by the SCHOMBURG
Group, along with our large range of
high quality products.

In order to stay at the forefront of a
continuously advancing market we are
always investing in research and
development of new and current
products. This guarantees high quality
products, which in turn leads to customer
satisfaction.



SCHOMBURG

SCHOMBURG GmbH & Co. KG
Aquafinstraße 2 - 8
D-32760 Detmold (Germany)
phone +49-52 31-953-00
fax +49-52 31-953-108
email export@schomburg.de
www.schomburg.com

